

# Submersible Compact Mixer (K)MR Series

The angular contact ball bearing resists to axial force. compact design.  
More efficient bulk flow.



MR



KMR



## Application

- Biological treatment tanks
- Equalization tanks
- Lime slurry storage tanks
- Ponds and rivers water circulation
- Heat exchanger
- Ice prevention

**PUMPTAC**

# Submersible Compact Mixer (K)MR Series

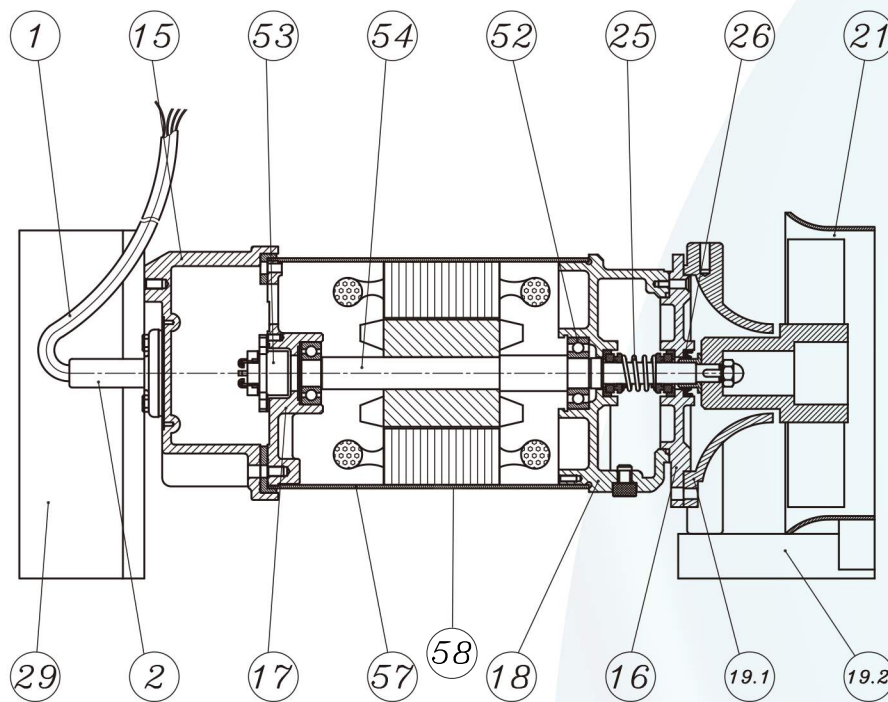

No.	PART	MR MATERIAL	KMR MATERIAL
1	Cable	STOW	STOW
2	Submersible Cable	PVC	PVC
15	Motor Cover	FC 200	SUS 316
16	Mechanical Seal Cover	FC 200	SUS 316
17	Bearing Cover	FC 200	FC 200
18	Power Side Bracket	FC 200	SUS 316
19.1	Diversion Bracket	FC 200	SUS 316
19.2	Jet Ring	SUS 304	SUS 304
21	Impeller	FCD 450	SUS 316
25	Mechanical Seal	Sic/Sic	Sic/Sic
26	Oil Seal	NBR	Viton
29	MR Track (Sliding Seat)	SUS 304	SUS 304
52	Bearing	NTN	NTN
53	Overload	TI	TI
54	Shaft	SUS 410	SUS 316
57	Motor Frame	SUS 304	SUS 316
58	Motor	IP68, Insulation Class F, 4 Pole	

# Submersible Compact Mixer (K)MR Series

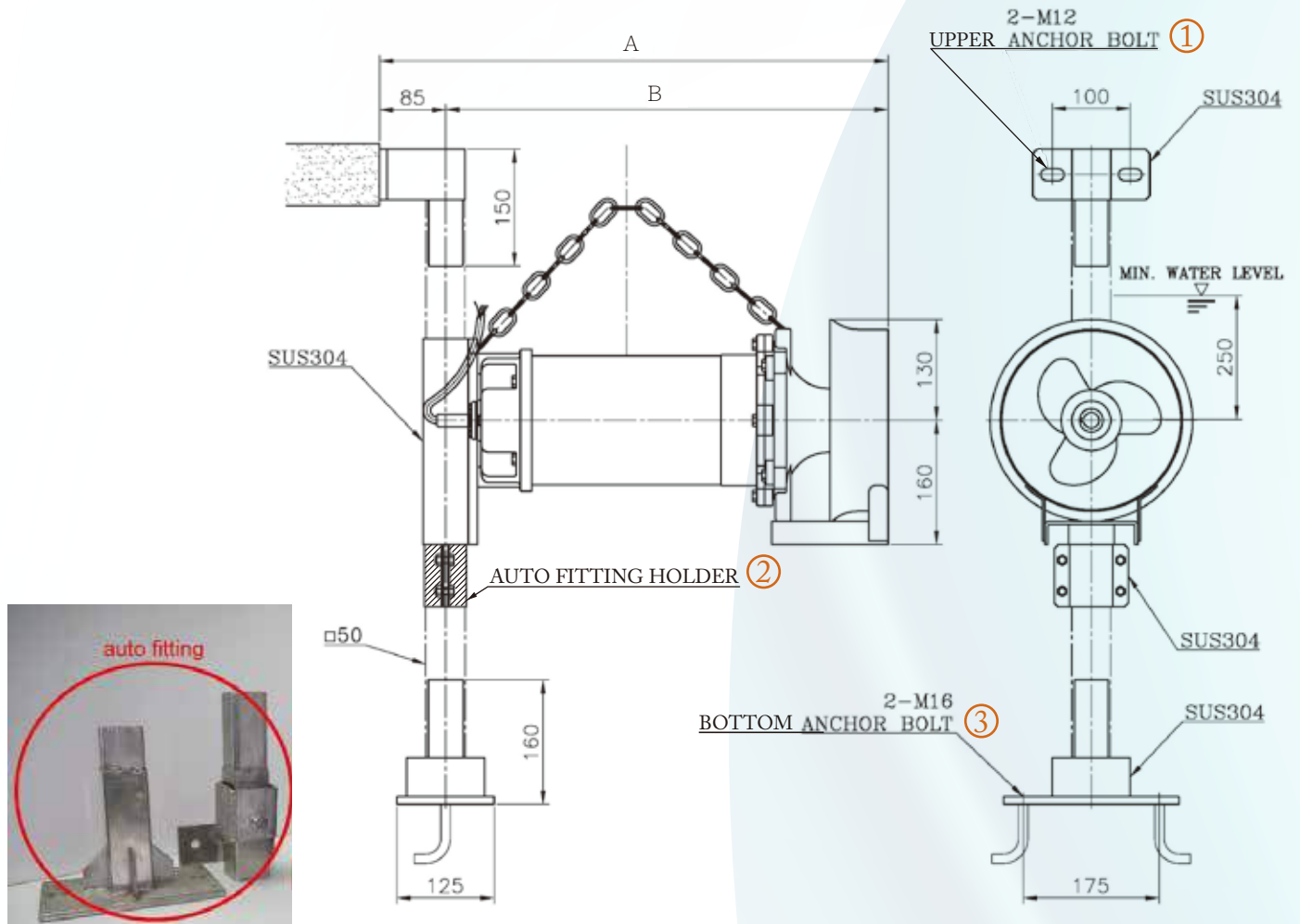

Model	Poles	Output		Capacity	Jet-Ring	Dimension(mm)	
	P	Kw	Hp	M <sup>3</sup> /min		A	B
(K)MR-4-4D	4	0.40	1/2	1.8	Standard	480	395
(K)MR-7-4D	4	0.75	1	3.2	Standard	510	425
(K)MR-15-4D	4	1.52	2	4.5	Standard	632	567
(K)MR-22-4D	4	2.23	3	6.8	Standard	652	587

AUTO FITTING INCLUDE ① UPPER ANCHOR BOLT ② AUTO FITTING HOLDER  
③ BOTTOM ANCHOR BOLT, NOT INCLUDING SQUARE PIPE.

# Submersible Compact Mixer (K)MR Series



## SUN MINES ELECTRICS CO.,LTD

Tel +886-2-2662-9292  
Fax +886-2-2662-7575  
Email [info@sunmines.com.tw](mailto:info@sunmines.com.tw)  
Website <https://www.blowtac.com.tw/en/>  
Address 7F, No.153, Sec. 3, Beishen Rd,  
Shenkeng Dist, New Taipei City 222, Taiwan.